

2 GRID A-5 COLUMN  
S1.1a

32\"/>

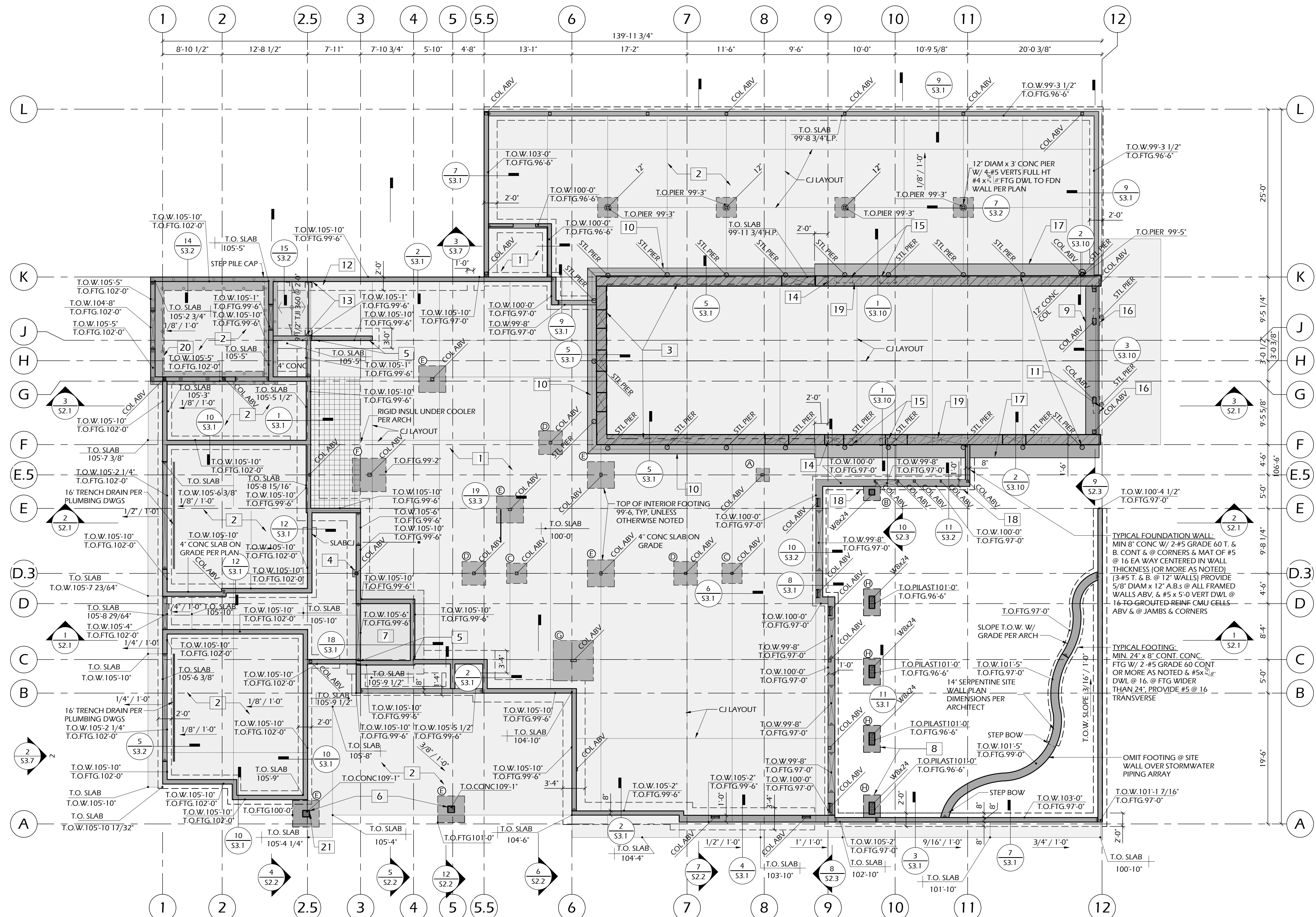

1 FOUNDATION PLAN  
S1.1a 1/8\"/>

**FOUNDATION PLAN KEYNOTES**

1	4\"/>
2	4\"/>
3	EXTENT OF UNDERPINNING GRADE BEAM UNDER STONE WALL
4	6\"/>
5	2-#6 X 8'-0\"/>
6	12\"/>
7	8\"/>

**FOUNDATION PLAN KEYNOTES**

8	TYP @ 4 LOCATIONS: 10\"/>
9	24\"/>
10	NEW MIN. 24\"/>
11	MICROPILE. DESIGN, CONST. ETC. PER MANUF. FOR 40k WORKING DESIGN LOAD W/ BRG PL & MIN 12x12x1/2 X 2'-6\"/>
12	1 1/2\"/>
13	2x10 TRTD LEDGER W/ 5/8\"/>
14	STEP BOT OF EXISTING STONE WALL

**FOUNDATION PLAN KEYNOTES**

15	UNDERPIN 8\"/>
16	OPTIONAL UNDERPINNING PIERS @ BOT OF 8\"/>
17	NEW MIN. 24\"/>
18	FOOTINGS ARE LOCATED IN THE DISTURBED ZONE FROM THE EXISTING BUILDING UNDERPINNING
19	EXCAVATE 16\"/>
20	2'-0\"/>
21	FROST DEPTH 102\"/>

**ISOLATED FOOTING SCHEDULE**

MARK	L	W	H	BAR SIZE	BAR QTY
A	2'-0"	2'-0"	8"	#5	3
B	2'-6"	2'-6"	8"	#5	3
C	3'-0"	3'-0"	8"	#5	4
D	3'-6"	3'-6"	8"	#5	4
E	4'-0"	4'-0"	10"	#5	5
F	5'-0"	5'-0"	1'-0"	#6	6
G	6'-0"	6'-0"	1'-0"	#6	8
H	4'-0"	2'-6"	8"	#5	4/3

**FOUNDATION PLAN:**

- ALL FOOTINGS TO BEAR ON MIN 6000PSF REMEDIATED SUBGRADE, CENTERED @ BEARING ELEMENTS. SET MIN 40\"/>
- TYPICAL INTERIOR FLOOR AND GARAGE SLAB TO BE MIN 4\"/>
- ALL DIMENSIONS TO BE CONFIRMED W/ ARCHITECTURAL DRAWINGS PRIOR TO CONSTRUCTION. NOTIFY OF ANY DISCREPANCIES.
- PROVIDE 5/8\"/>
- PROJECT #5 X 5'-0\"/>
- PROJECT 100'-0\"/>

PROJECT No:  
ISSUE DATE: 12/17/21  
REVISIONS:  
Permit Set 12/17/2021  
ASI 02 07/29/2022  
Delta 3 08/31/2022  
ASI 06 12/14/2022

FOUNDATION PLAN

SHEET NUMBER:

**S1.1a**